

ANSI Standard Roller Chains

precision power transmission roller chains meet or exceed ANSI standard B29.1. Supplied in single and multiple strands of ANSI sizes from 3/8" to 3" pitch.

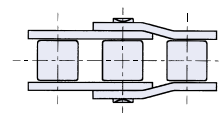

2Pitch Offset

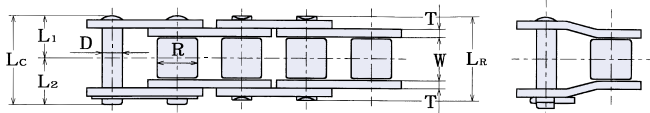
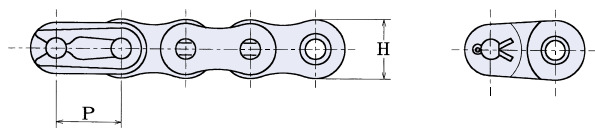
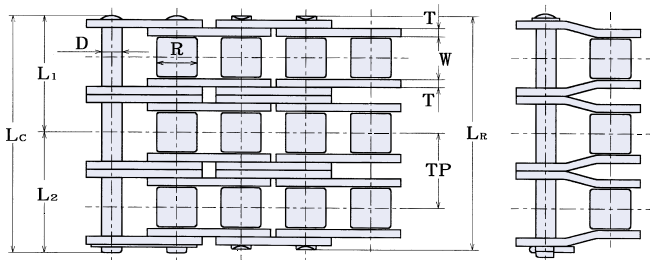

Item	See Page	
Attachment Chain	66	67
Rustless	36	40 43
SL Self-Lube Chain	49	
SLR Self-Lube Chain	52	53
Drive Chain Selection	76	77
Horsepower Rating	82	

Standard Packing	SY35	SY40
1 Uni(10')	320P	240P
On a Reel	250'	200'

35 (BUSHED CHAIN)

Chain No. (ANSI)	Dimensions - mm											Average Ultimate Strength kN	Maximum Allowable Load kN	Average Chain Weight kg/m
	Pitch P	Bushing		Pin				Plate		Trans. Pitch TP				
		Width W	Dia. R	Dia. D	Length		Height H	Thick. T						
35	9.525	4.78	5.08	3.58	12.0	12.9	6.0	6.9	9.0	1.25	-	10.8	2.48	0.34
35-2					22.1	23.0	11.1	11.9			10.1	21.6	3.67	0.63
35-3					32.2	33.1	16.1	17.0				32.4	5.40	0.92
35-4					42.3	43.2	21.2	22.0				43.2	7.13	1.22
35-5					52.4	53.2	26.2	27.0				54.0	8.42	1.56
35-6					62.5	63.5	31.3	32.2				64.8	9.94	1.89

40

Chain No. (ANSI)	Dimensions - mm											Average Ultimate Strength kN	Maximum Allowable Load kN	Average Chain Weight kg/m
	Pitch P	Roller		Pin				Plate		Trans. Pitch TP				
		Width W	Dia. R	Dia. D	Length		Height H	Thick. T						
40	12.70	7.95	7.92	3.96	16.5	17.9	8.3	9.6	11.7	1.5	-	19.1	4.17	0.60
40-2					30.8	32.2	15.4	16.8			14.4	38.2	6.17	1.22
40-3					45.0	46.6	22.5	24.1				57.3	9.08	1.85
40-4					60.0	60.8	30.0	30.8				76.4	12.0	2.46
40-5					74.6	75.6	37.3	38.3				95.5	14.2	3.14
40-6					89.0	89.9	44.5	45.4				115.0	16.7	3.31

Refer to page 80. " Selection of offset link "

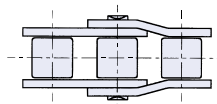
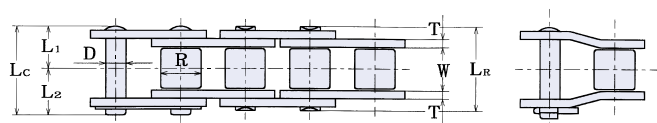

2Pitch Offset

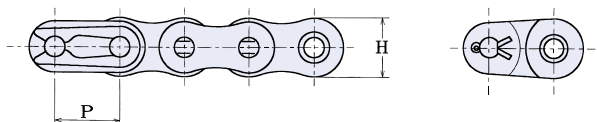
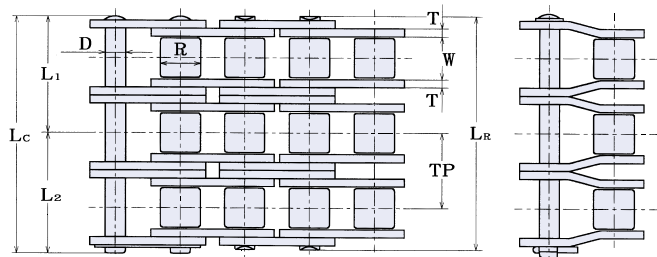

Item	See Page	
Attachment Chain	60	67
Rustless	36	40 43
SL Self-Lube Chain	49	
SLR Self-Lube Chain	52	53
Drive Chain Selection	76	77
Horsepower Rating	82	83

Standard Packing	SY50	SY60
1 Uni(10')	192P	160P
On a Reel	100'	100'

50

Chain No. (ANSI)	Dimensions - mm											Average Ultimate Strength kN	Maximum Allowable Load kN	Average Chain Weight kg/m
	Pitch P	Rollre		Pin				Plate		Trans. Pitch TP				
		Width W	Dia. R	Dia. D	Length				Height H		Thick. T			
					LR	LC	L1	L2						
50	15.875	9.53	10.16	5.08	20.4	22.0	10.2	11.8	14.6	2.0	-	31.9	7.22	0.98
50-2							38.4	40.0	19.2	20.8	18.1	63.8	10.7	2.00
50-3							56.7	58.2	28.4	29.8		95.7	15.7	3.07
50-4							75.0	75.7	37.5	38.2		128	20.7	3.97
50-5							93.2	94.1	46.6	47.5		160	24.5	5.02
SY50-6							111.4	112.5	55.7	56.8		191	28.9	6.01

60

Chain No. (ANSI)	Dimensions - mm											Average Ultimate Strength kN	Maximum Allowable Load kN	Average Chain Weight kg/m
	Pitch P	Roller		Pin				Plate		Trans. Pitch TP				
		Width W	Dia. R	Dia. D	Length				Height H		Thick. T			
					LR	LC	L1	L2						
60	19.05	12.70	11.91	5.95	25.5	26.9	12.8	14.1	17.5	2.4	-	43.1	10.7	1.46
60-2							48.2	49.7	24.0	25.7	22.8	86.2	14.7	2.95
60-3							71.2	72.6	35.2	37.4		129	21.6	4.43
60-4							94.4	95.4	47.2	48.2		172	28.5	5.92
60-5							117.0	118.2	58.5	59.7		216	33.7	7.41
60-6							140.0	140.9	70.1	70.8		259	39.7	8.90
60-8							185.0	186.6	92.5	94.1		345	53.5	13.36
SY60-10							230.8	232.2	115.4	116.8		431	64.7	16.34

Refer to page 80. " Selection of offset link "

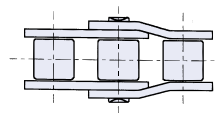
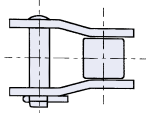
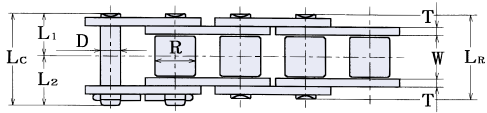

2Pitch Offset

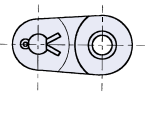
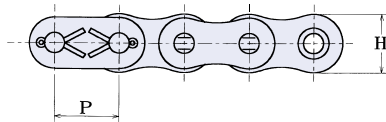
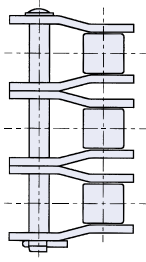
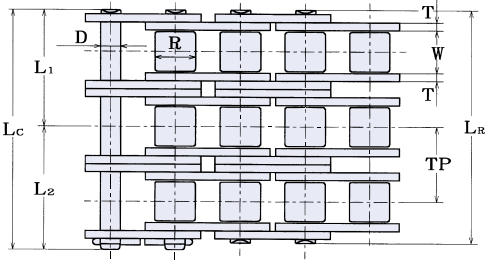

Item	See Page	
Attachment Chain	66	67
Rustless	36	40 43
SL Self-Lube Chain	49	
SLR Self-Lube Chain	52	53
MF Maintenance Free	57	
Drive Chain Selection	76	77
Horsepower Rating	83	

Standard Packing	SY80	SY100
1 Uni(10')	120P	96P

80

Chain No. (ANSI)	Dimensions - mm											Average Ultimate Strength kN	Maximum Allowable Load kN	Average Chain Weight kg/m
	Pitch P	Roller		Pin				Plate		Trans. Pitch TP				
		Width W	Dia. R	Dia. D	Length		Height H	Thick. T						
					LR	LC	L1	L2						
80	25.40	15.88	15.88	7.93	32.8	35.5	16.4	19.1	23.4	3.2	-	78.5	19.1	2.52
80-2					61.6	64.5	30.8	33.7			29.3	157	25.0	5.10
80-3					90.9	94.1	45.5	48.6				236	36.8	7.68
80-4					120.4	123.5	60.2	63.3				314	48.5	10.25
80-5					149.8	152.8	74.9	77.9				393	57.3	12.84
80-6					179.1	182.1	89.6	92.5				471	67.6	15.42
80-8					237.6	240.6	118.8	121.8				628	91.1	20.58
Y80-10					296.2	299.2	148.1	151.1				785	110	25.81

100

Chain No. (ANSI)	Dimensions - mm											Average Ultimate Strength kN	Maximum Allowable Load kN	Average Chain Weight kg/m
	Pitch P	Roller		Pin				Plate		Trans. Pitch TP				
		Width W	Dia. R	Dia. D	Length		Height H	Thick. T						
					LR	LC	L1	L2						
100	31.75	19.05	19.05	9.53	39.4	43.0	19.7	23.3	29.3	4.0	-	118	29.4	3.91
100-2					75.1	78.8	37.6	41.2			35.8	236	38.4	7.74
100-3					110.9	114.6	55.5	59.1				354	56.5	11.58
100-4					147.4	150.8	73.7	77.1				472	74.6	15.40
100-5					183.0	186.6	91.5	95.1				590	88.1	19.26
100-6					218.8	222.4	109.4	113.0				708	104	23.10
100-8					290.4	294.1	145.2	148.9				944	140	30.81
100-10					362.0	365.7	181.0	184.7				1180	170	38.54

Refer to page 80. " Selection of offset link "

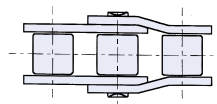
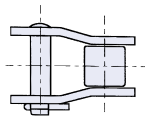
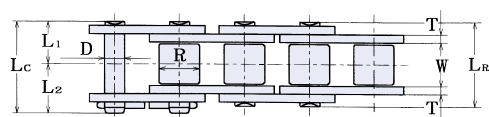

2Pitch Offset

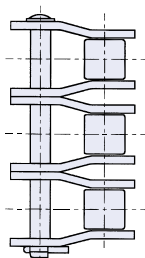
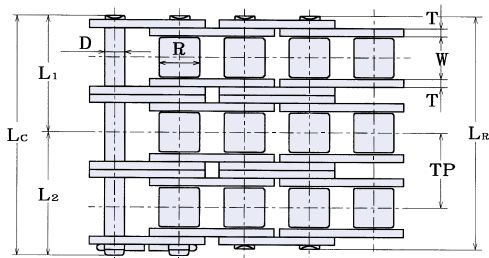

Item	See Page	
Attachment Chain	66	67
Rustless	36	40
SL Self-Lube Chain	49	
MF Maintenance Free	57	
Drive Chain Selection	76	77
Horsepower Ratings	84	

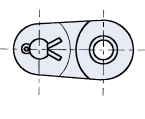
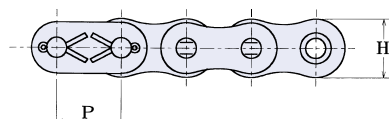

Standard Packing	SY120	SY140
1 Unit(10')	80P	68P

120

Chain No. (ANSI)	Dimensions - mm											Average Ultimate Strength kN	Maximum Allowable Load kN	Average Chain Weight kg/m
	Pitch P	Roller		Pin				Plate		Trans. Pitch TP				
		Width W	Dia. R	Dia. D	Length		Height H	Thick. T						
120	38.10	25.40	22.23	11.10	49.5	53.4	24.8	28.6	35.1	4.8	-	167	39.5	5.76
120-2					94.9	98.8	47.5	51.3			45.4	334	51.7	11.49
120-3					140.3	144.2	70.2	74.0				501	76.0	17.20
120-4					186.1	190.0	93.1	96.9				668	100	22.92
120-5					231.5	235.4	115.8	119.6				835	119	28.65
120-6					276.9	280.8	138.5	142.3				1002	140	34.36
120-8					367.5	371.7	183.8	187.9				1336	188	45.81
SY120-10					458.3	462.5	229.2	233.3				1670	228	57.38

140

Chain No. (ANSI)	Dimensions - mm											Average Ultimate Strength kN	Maximum Allowable Load kN	Average Chain Weight kg/m
	Pitch P	Roller		Pin				Plate		Trans. Pitch TP				
		Width W	Dia. R	Dia. D	Length		Height H	Thick. T						
140	44.45	25.40	25.4	12.70	54.0	58.3	27.0	31.3	40.9	5.6	-	216	52.3	7.41
140-2					102.9	107.2	51.5	55.7			48.9	432	68.3	14.63
140-3					151.7	156.3	75.9	80.4				648	101	21.91
140-4					201.2	205.5	100.6	104.9				864	133	29.17
140-5					250.1	254.4	125.1	129.3				1080	157	36.45
140-6					299.0	303.3	149.5	153.8				1296	185	43.72
140-8					396.5	401.1	198.3	202.8				1728	249	58.28
140-10					494.3	498.9	247.2	251.7				2160	302	72.82

Refer to page 80. " Selection of offset link "

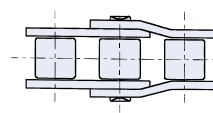
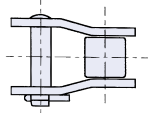
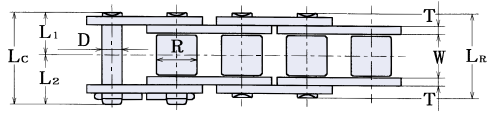

2Pitch Offset

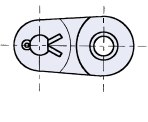
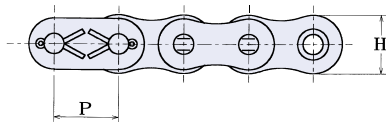
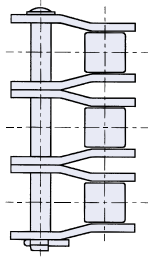
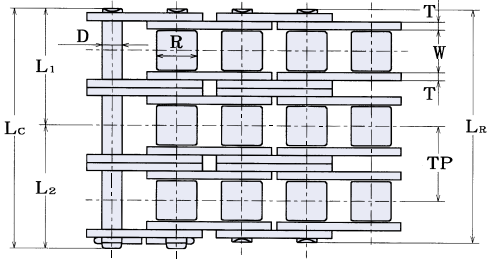

Item	See Page	
Attachment Chain	66	67
Rustless	36	40
SL Self-Lube Chain	49	
MF Maintenance Free	57	
Drive Chain Selection	76	77
Horsepower Ratings	84	85

Standard Packing	SY160	SY180
1 Unit(10')	60P	54P

160

Chain No. (ANSI)	Dimensions - mm											Average Ultimate Strength kN	Maximum Allowable Load kN	Average Chain Weight kg/m
	Pitch P	Roller		Pin				Plate		Trans. Pitch TP				
		Width W	Dia. R	Dia. D	Length			Height H	Thick. T					
					LR	LC	L1	L2						
160	50.80	31.75	28.58	14.28	64.3	68.7	32.2	36.5	46.7	6.4	-	275	69.0	9.79
160-2					122.8	127.2	61.4	65.8			58.5	550	90.1	19.45
160-3					181.3	185.7	90.7	95.0				825	133	29.17
160-4					240.3	244.7	120.2	124.5				1100	175	38.77
160-5					298.8	303.3	149.4	153.9				1375	207	48.43
160-6					357.4	361.7	178.7	183.0				1650	244	58.08
160-8					474.4	478.8	237.2	241.6				2200	329	77.39
SY160-10					591.4	595.8	295.7	300.1				2750	398	102.86

180

Chain No. (ANSI)	Dimensions - mm											Average Ultimate Strength kN	Maximum Allowable Load kN	Average Chain Weight kg/m
	Pitch P	Roller		Pin				Plate		Trans. Pitch TP				
		Width W	Dia. R	Dia. D	Length			Height H	Thick. T					
					LR	LC	L1	L2						
180	57.15	35.70	35.70	17.45	72.5	78.4	36.3	42.1	52.5	7.2	-	353	79.0	13.39
180-2					138.2	144.0	69.1	74.9			65.8	706	98.4	26.62
180-3					204.5	210.2	102.3	107.9				1059	145	39.85
180-4					270.2	275.9	135.1	140.8				1412	191	53.08
180-5					336.0	341.6	173.6	173.7				1765	226	66.31
180-6					401.8	407.3	200.9	206.4				2118	266	79.54

Refer to page 80. " Selection of offset link "

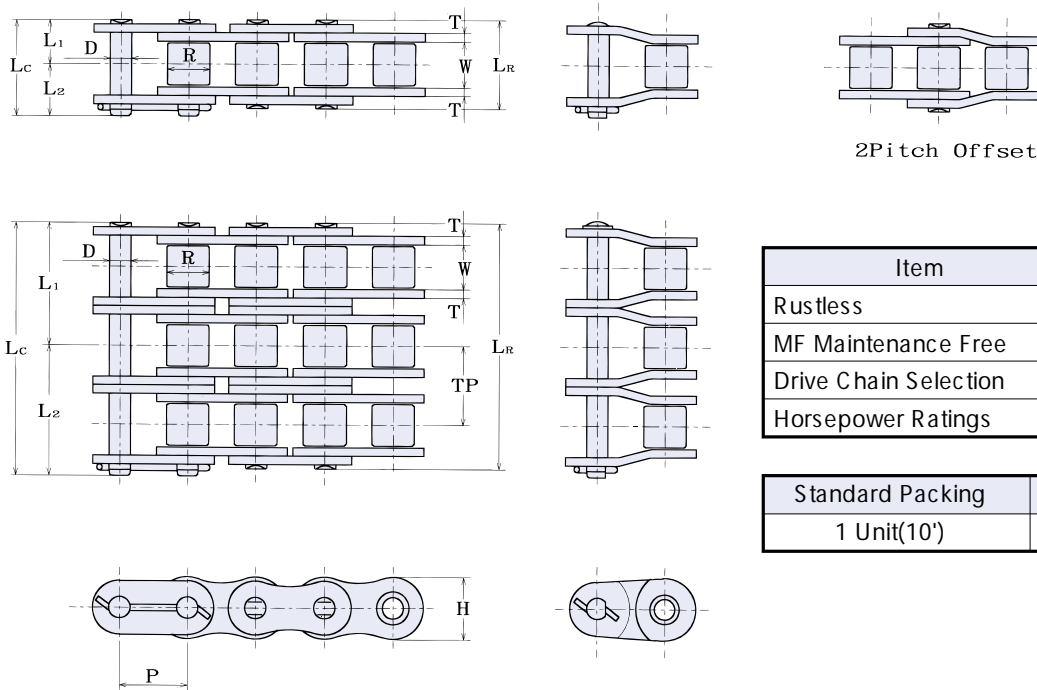

Item	See Page
Rustless	40
MF Maintenance Free	57
Drive Chain Selection	76 77
Horsepower Ratings	85

Standard Packing	SY200	SY240
1 Unit(10')	48P	40P

200

Chain No. (ANSI)	Dimensions - mm											Average Ultimate Strength kN	Maximum Allowable Load kN	Average Chain Weight kg/m
	Pitch P	Roller		Pin				Plate		Trans. Pitch TP				
		Width W	Dia. R	Dia. D	Length		Height H	Thick. T						
200	63.50	38.10	39.67	19.83	78.5	87.0	39.3	47.7	59.8	8.0	-	451	93	16.93
200-2					150.2	158.7	75.1	83.6			71.6	902	122	33.73
200-3					221.7	230.2	110.9	119.3				1353	179	50.53
200-4					293.3	302.4	146.7	155.7				1804	236	67.34
200-5					365.5	374.0	182.8	191.2				2255	279	84.14
200-6					437.1	445.6	218.6	227.0				2706	329	100.94

240

Chain No. (ANSI)	Dimensions - mm											Average Ultimate Strength kN	Maximum Allowable Load kN	Average Chain Weight kg/m
	Pitch P	Roller		Pin				Plate		Trans. Pitch TP				
		Width W	Dia. R	Dia. D	Length		Height H	Thick. T						
240	76.20	47.63	47.63	23.78	96.4	104.1	48.2	55.9	70.3	9.5	-	677	129	23.64
240-2					184.2	191.8	92.1	99.7			87.8	1354	167	47.13
240-3					272.0	279.6	136.0	143.6				2031	245	70.61
240-4					359.8	367.4	179.9	187.5				2708	324	94.09
240-5					447.6	455.2	223.8	231.4				3385	383	117.56
240-6					535.5	543.0	267.8	275.2				4062	451	141.06

Refer to page 80. " Selection of offset link "